

SPX 527



LIFT ANYWHERE YOU NEED!

**CE**  
UNI EN 13000



2,7 t



3,4 - 12,1 m

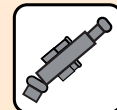

2,1 - 4,1 m



(m/t)



3,4 - 12,1 m +

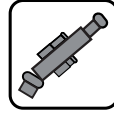



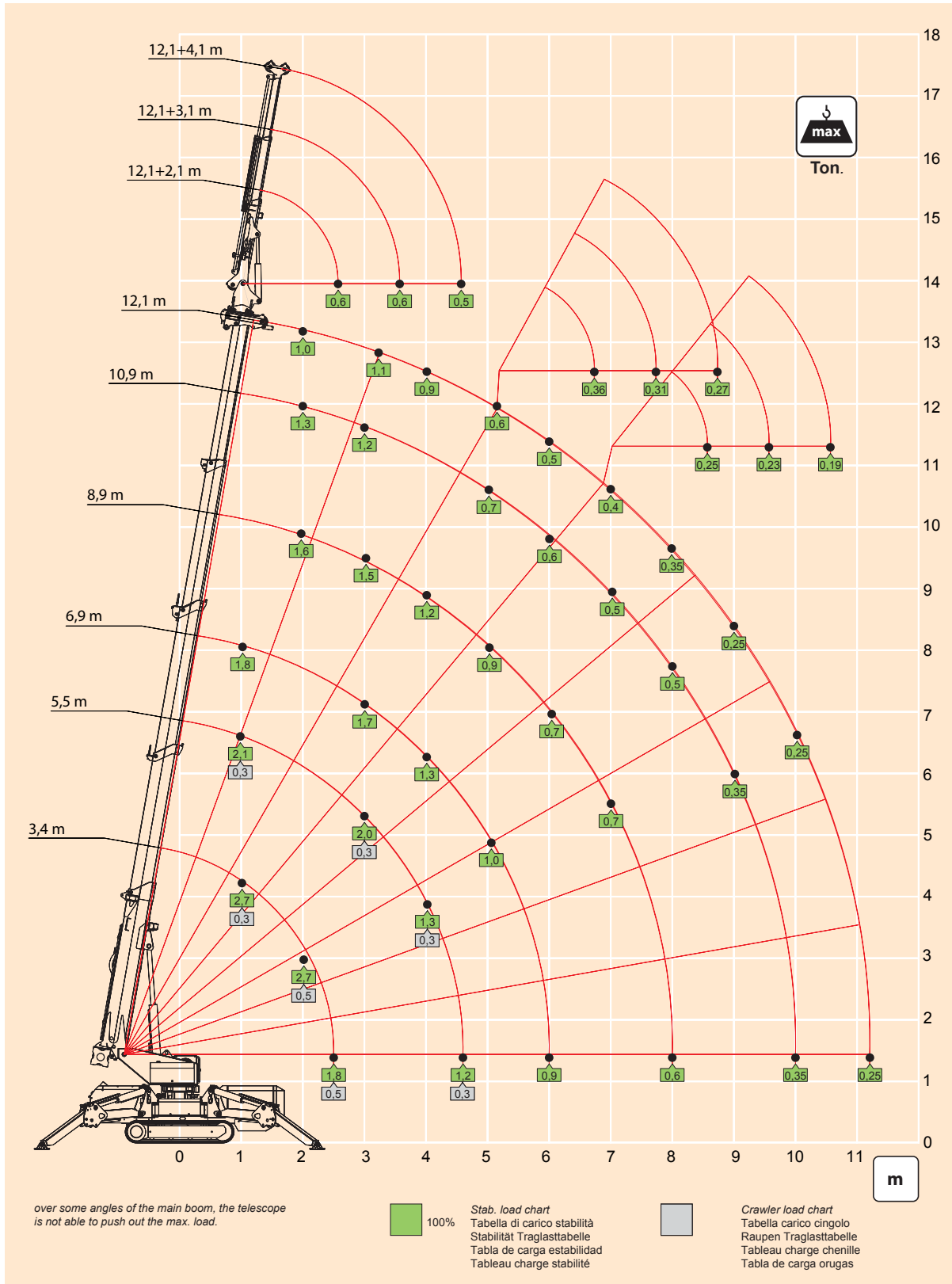

2,1 - 4,1 m

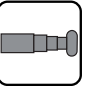
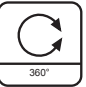

## Data - Dati - Daten - Datos - Caractéristiques

	Crane Less Counterweight - Gru senza contrappeso - Kran ohne Gegengewicht - Grúa sin contrapeso - Grue sans contrepoids	3700 kg
	Counterweight - Contrappeso - Gegengewicht - Contrapeso - Contrepoids	---- kg
	4 ton Block - Blocco 4 ton - Block 4 Ton - Bloqueo 4 Ton - Bloc 4 Ton	20 kg
	Hydraulic Jib J600H - Jib idraulico J600H - Hydraulischer Ausleger J600H - Plumín hidráulico J600H - Flèche télescopique J600H	200 kg

	<p><b>Engine:</b> 3 cylinders water cooled diesel, ISUZU mod. 3CB1, 2 rpm levels, EPA TIER 3  <b>Motore:</b> 3 cilindri diesel raffreddato a liquido, ISUZU mod. 3CB1, 2 livelli di regime, EPA TIER 3  <b>Motor:</b> Wassergekühlter 3 Zylinder Diesel Motor, ISUZU mod. 3CB1, 2 rpm, EPA TIER 3  <b>Motor:</b> Diesel 3 cilindros con refrigeración por aire, ISUZU mod. 3CB1, 2 niveles rpm, EPA TIER 3  <b>Moteur:</b> Diesel 3 cylindres, refroidissement à eau, ISUZU mod. 3CB1, accélérateur à 2 niveaux, EPA TIER 3</p>
---	---

	<p><b>Telescopic Boom:</b> 1 base and 4 telescopic sections high-tensile structural steel. All sections synchronized and full power.  <b>Braccio Telescopico:</b> 1 braccio principale e 4 telescopici in acciaio strutturale ad alta resistenza. Sfilo completamente idraulico e sincronizzato.  <b>Teleskopausleger:</b> 1 Hauptausleger + 4 Hochwiderstand Stahl Teleskopausleger. Voll hydraulischer und teleskopierbarer Ausleger.  <b>Pluma Telescópica:</b> 1 pluma principal y 4 telescópicas en acero de alta resistencia. Elementos sincronizados e hidráulicos.  <b>Flèche Téléscopique:</b> 1 flèche principale et 4 téléscopiques en acier à haute résistance. Éléments synchronisés et hydrauliques.</p>		
	360°	approx 45" - circa 45" - ca. 45" - aproximadamente 45" - env. 45"	
	-2° + 80°	approx 15" - circa 15" - ca. 15" - aproximadamente 15" env. 15"	
	3,4 m + 12,1 m	approx 35" - circa 35" - ca. 35" - aproximadamente 35" env. 35" w	
	Rope - Fune- Seil - Cable - Câble		<p>Permissible line pulls max.                      Trazioni ammissibili della linea                      Seilzug                      Tracciones del cable admisibles                      Effort maxi au brin</p>
S1: 0 - 30 m/min	<p>Single line                      Tiro a fune singola                      Für einfachen Strang                      Ramal simple                      Brin simple</p>	Ø 8 mm / L 60 m	1434 da N

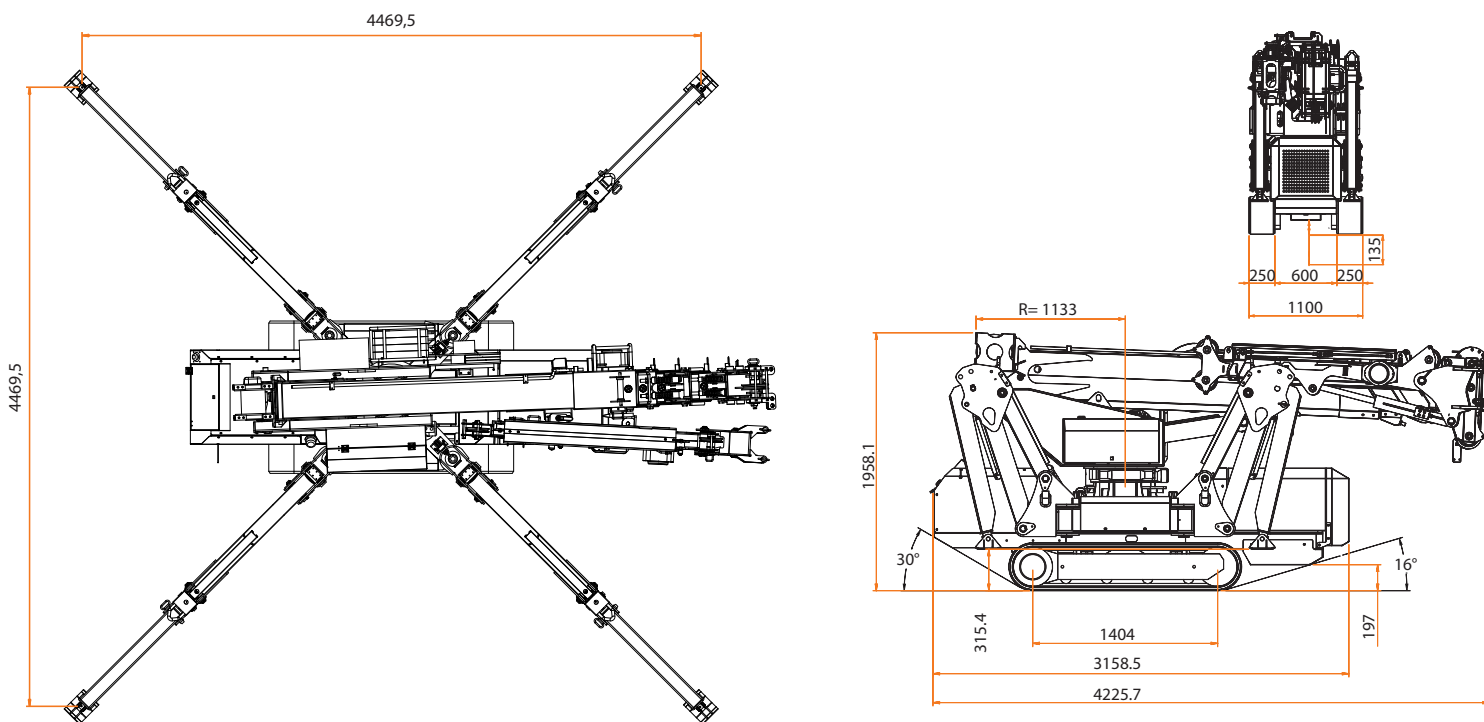

Notes: All specifications and features herein described can be changed without prior advice. All indicated data are indicative only and are not binding as crane performs differently depending on its use.

Note: Tutte le caratteristiche e le specifiche descritte possono essere soggette a variazioni senza preavviso. Tutti i dati riportati sono forniti a puro titolo informativo e non sono impegnativi dal momento che le prestazioni della macchina variano in funzione dell'utilizzo.

Hinweise: Unangekündigte Änderungen sämtlicher Eigenschaften und Daten sind möglich. Alle Angaben sind Richtwerte und nicht verbindlich da die Leistungen der Vorrichtung von deren Einsatz abhängen.

Notes: Todas las características y las especificaciones aquí indicadas pueden ser sujetas a variaciones sin aviso. Se dan todos los datos aquí indicados como simples informaciones. No se consideran como vinculantes, dado que las prestaciones del maquinario pueden variar.

Notes: Toutes les caractéristiques et le spécifications descriptives peut être sujet à variation sans préavis. Tout les données rapportés sont fourni à titre informatif et ne sont pas engager au moment que la prestation de la machine change en fonction de l'emploi.